

**TN**

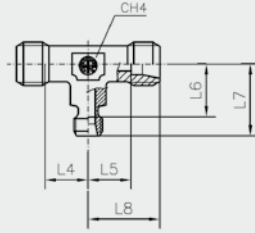

**TS**

**TN/TS 100 R L**

- Raccordo a Tee ridotto
- Reduced-Tee

Serie Series	Ø Tubo O.D. d <sub>1</sub>	Ø Tubo O.D. d <sub>2</sub>	Ø Tubo O.D. d <sub>3</sub>	PN	L1	L2	L3	L4 L5 L6	L7	L8	CH1	CH2	CH3	CH4	Completo Complete		Peso-Weight kg.×100 P.	
															Articolo Item	Codice Code	Completo Complete	Solo corpo Only body
L	6	8	6	315	29	29	29	12	21	21	14	17	14	12	TN 100 R- 6- 8- 6 L	TN100L06L08L06	6,8	3,0
	8	6	8		29	29	29	12	21	21	17	14	17	12	TN 100 R- 8- 6- 8 L	TN100L08L06L08	7,3	2,9
	6	10	6		30	30	30	15	22	22	14	19	14	14	TN 100 R- 6-10- 6 L	TN100L06L10L06	8,2	4,0
	8	10	8		30	30	30	15	22	22	17	19	17	14	TN 100 R- 8-10- 8 L	TN100L08L10L08	9,4	4,0
	10	6	10		30	30	30	15	22	22	19	14	19	14	TN 100 R-10- 6-10 L	TN100L10L06L10	8,2	3,8
	10	8	10		30	30	30	15	22	22	19	17	19	14	TN 100 R-10- 8-10 L	TN100L10L08L10	9,5	3,9
	10	10	6		30	30	30	15	22	22	19	19	14	14	TN 100 R-10-10- 6 L	TN100L10L10L06	8,9	3,8
	8	12	8		32	32	32	17	24	24	17	22	17	17	TN 100 R- 8-12- 8 L	TN100L08L12L08	11,6	5,4
	12	6	12		32	32	32	17	24	24	22	14	22	17	TN 100 R-12- 6-12 L	TN100L12L06L12	11,8	5,1
	12	8	8		32	32	32	17	24	24	22	17	17	17	TN 100 R-12- 8- 8 L	TN100L12L08L08	11,6	5,6
	12	8	12		32	32	32	17	24	24	22	17	22	17	TN 100 R-12- 8-12 L	TN100L12L08L12	12,2	5,0
	12	10	10		32	32	32	17	24	24	22	19	19	17	TN 100 R-12-10-10 L	TN100L12L10L10	12,1	5,1
	12	10	12		32	32	32	17	24	24	22	19	22	17	TN 100 R-12-10-12 L	TN100L12L10L12	12,6	5,1
	12	12	10		32	32	32	17	24	24	22	22	19	17	TN 100 R-12-12-10 L	TN100L12L12L10	12,5	5,0
	10	15	10		36	36	36	21	28	28	19	27	19	19	TN 100 R-10-15-10 L	TN100L10L15L10	18,1	9,4
	12	15	12		36	36	36	21	28	28	22	27	22	19	TN 100 R-12-15-12 L	TN100L12L15L12	19,0	8,9
	15	6	15		36	36	36	21	28	28	27	14	27	19	TN 100 R-15- 6-15 L	TN100L15L06L15	19,4	9,2
	15	10	15		36	36	36	21	28	28	27	19	27	19	TN 100 R-15-10-15 L	TN100L15L10L15	20,2	9,1
	15	12	12		36	36	36	21	28	28	27	22	22	19	TN 100 R-15-12-12 L	TN100L15L12L12	19,3	8,9
	15	12	15		36	36	36	21	28	28	27	22	27	19	TN 100 R-15-12-15 L	TN100L15L12L15	20,8	9,0
	15	15	12		36	36	36	21	28	28	27	27	22	19	TN 100 R-15-15-12 L	TN100L15L15L12	20,9	9,2
	12	18	12		38,5	40	38,5	23,5	31	31	22	32	22	24	TN 100 R-12-18-12 L	TN100L12L18L12	26,3	13,9
	18	10	10		40	38,5	38,5	23,5	31	31	32	19	19	24	TN 100 R-18-10-10 L	TN100L18L10L10	25,8	14,2
	18	10	18		40	38,5	40	23,5	31	31	32	19	32	24	TN 100 R-18-10-18 L	TN100L18L10L18	29,3	13,9
	18	12	18		40	38,5	40	23,5	31	31	32	22	32	24	TN 100 R-18-12-18 L	TN100L18L12L18	29,7	13,2
	18	15	18		40	38,5	40	23,5	31	31	32	27	32	24	TN 100 R-18-15-18 L	TN100L18L15L18	31,7	13,6
	18	18	10		40	40	38,5	23,5	31	31	32	32	19	24	TN 100 R-18-18-10 L	TN100L18L18L10	29,6	13,8
	L	22	10		22	160	44	42,5	44	27,5	35	35	36	19	36	27	TN 100 R-22-10-22 L	TN100L22L10L22
22		12	22	44	42,5		44	27,5	35	35	36	22	36	27	TN 100 R-22-12-22 L	TN100L22L12L22	39,6	19,6
22		15	15	44	42,5		42,5	27,5	35	35	36	27	27	27	TN 100 R-22-15-15 L	TN100L22L15L15	40,8	22,2
22		15	22	44	42,5		44	27,5	35	35	36	27	36	27	TN 100 R-22-15-22 L	TN100L22L15L22	41,6	19,4
22		18	18	44	44		44	27,5	35	35	36	32	32	27	TN 100 R-22-18-18 L	TN100L22L18L18	44,0	21,7
22		18	22	44	44		44	27,5	35	35	36	32	36	27	TN 100 R-22-18-22 L	TN100L22L18L22	43,8	19,2
22		22	18	44	44		44	27,5	35	35	36	36	32	27	TN 100 R-22-22-18 L	TN100L22L22L18	43,5	19,7
28		10	28	47	45,5		47	30,5	38	38	41	19	41	36	TN 100 R-28-10-28 L	TN100L28L10L28	55,4	33,4
28		12	28	47	45,5		47	30,5	38	38	41	22	41	36	TN 100 R-28-12-28 L	TN100L28L12L28	54,4	31,8
28		15	28	47	45,5		47	30,5	38	38	41	27	41	36	TN 100 R-28-15-28 L	TN100L28L15L28	56,4	31,7
28		18	28	47	47		47	30,5	38	38	41	32	41	36	TN 100 R-28-18-28 L	TN100L28L18L28	59,4	32,4
28		22	22	47	47		47	30,5	38	38	41	36	36	36	TN 100 R-28-22-22 L	TN100L28L22L22	61,6	34,1
28	22	28	47	47	47	30,5	38	38	41	36	41	36	TN 100 R-28-22-28 L	TN100L28L22L28	58,6	30,3		

- Le dimensioni di ingombro si intendono a raccordo chiuso.

- Overall sizes are with closed fitting.

- Per ordinare i raccordi in ACCIAIO INOX (AISI 316) sostituire nel codice di ordinazione la lettera "T" con la lettera "I"

- To order stainless steel fittings (AISI 316), replace the letter "T" with the letter "I"

- Per ordinare il "solo corpo" sostituire la lettera "N" con la lettera "S"

- To order only body replace the letter "N" with the letter "S"